

Assembly Instructions - PRO-II



Attention:



Storage cupboard is made from high quality veneered chipboard guaranteeing maximum resistance and long service life.



Drawers assembly

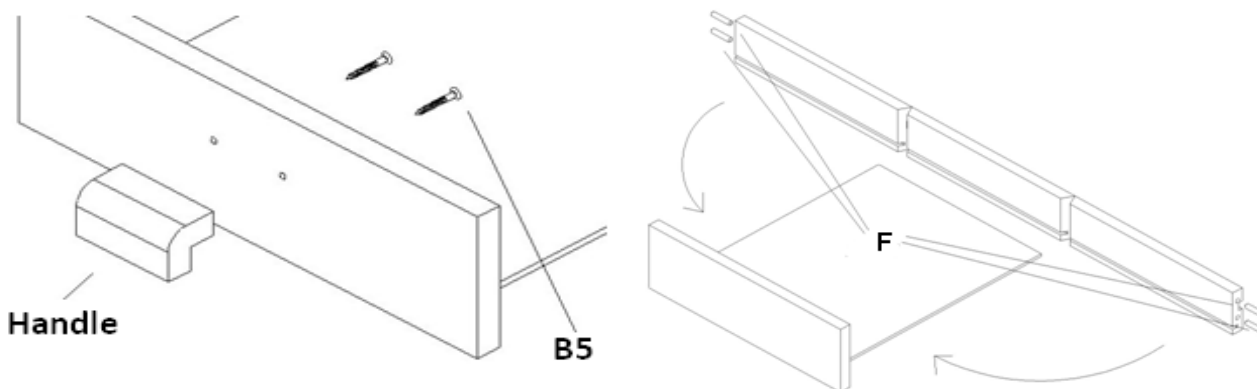

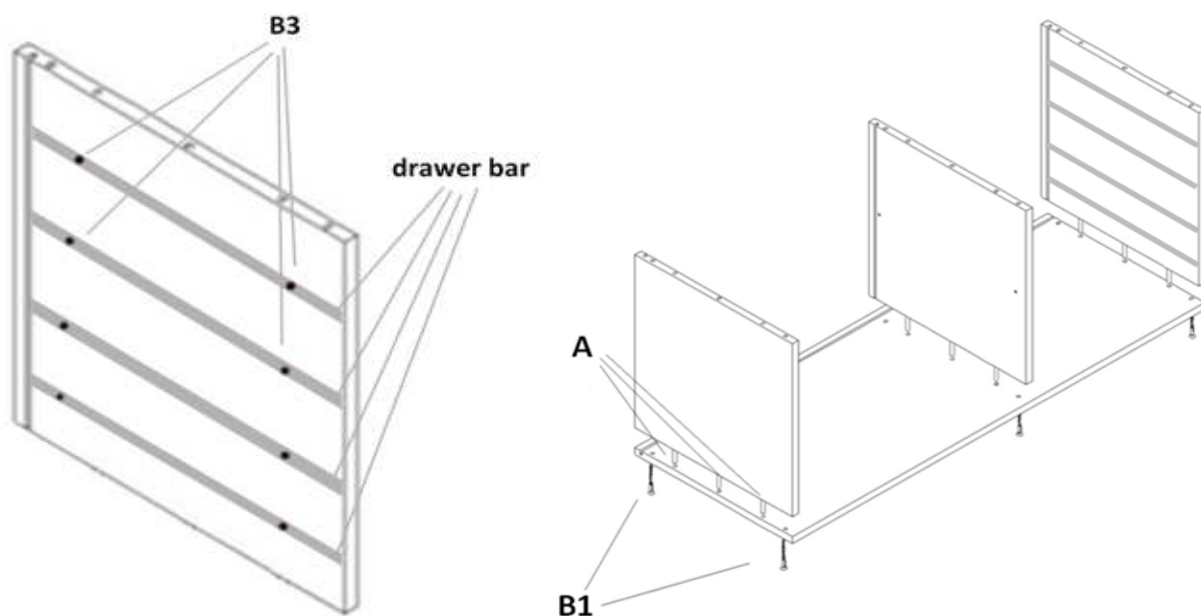

Use B3 screws (4x25mm) to screw wooden drawer bars to right and middle side of cupboard. Holes for screws are predrilled. Repeat the same on middle side of cupboard

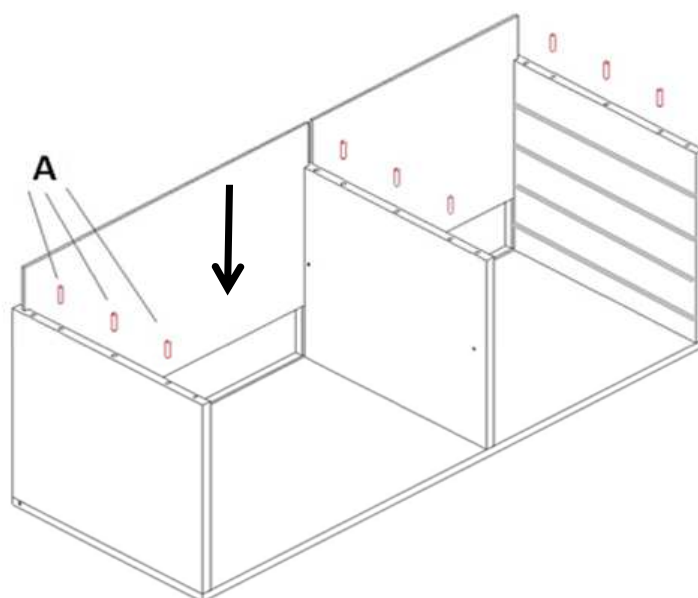

Right/Left doors

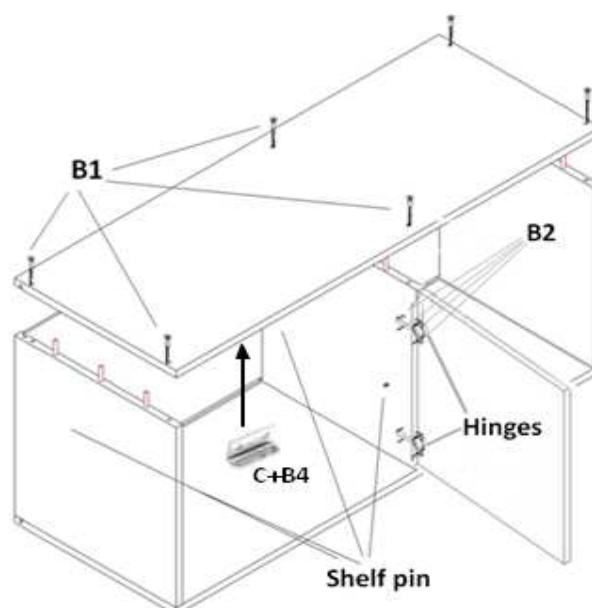
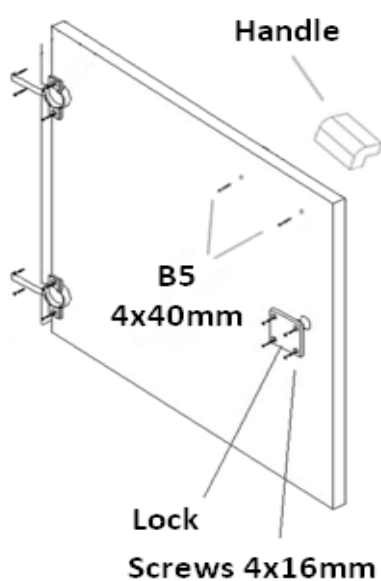

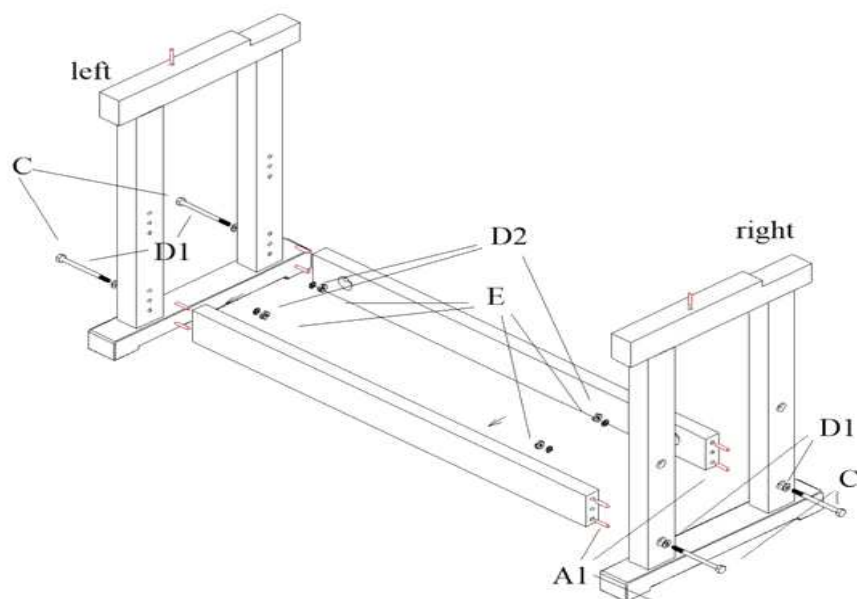

Place (insert) the cupboard on the lower stretchers of bench frame and attach the cupboard by screws - 4x40mm screws.

Hint: don't glue dowels of the stretchers of bench frame. Dowel has only guide function.

